

Description & Features :

- ❖ Material SS316 or SS304
- ❖ 1/4", 3/8", 1/2", 3/4" & 1" BSP or NPT connection
- ❖ Pressure Rated up to 400 kg/cm2 and higher

Applications :

- ❖ Needle Valves are used for flow control, isolation purpose, on /off applications. Suitable for pressure up to 400 kg/cm2 and higher.

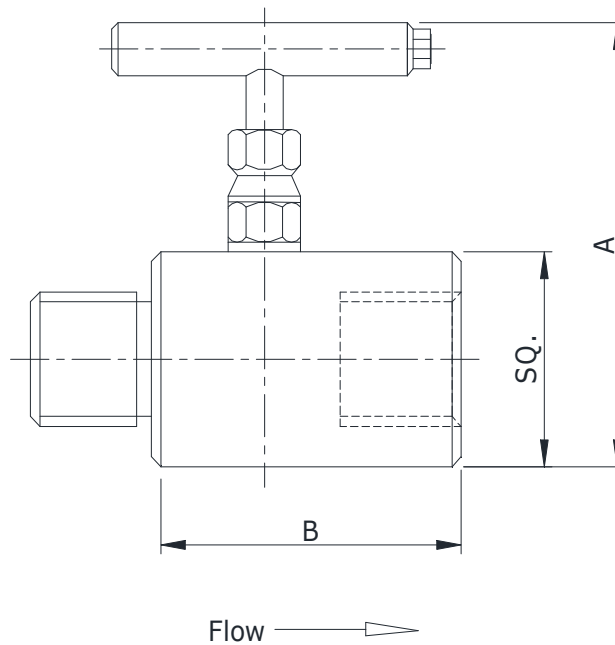

SIZE	A	B	SQ.
1/4"	93	65	25
3/8"	93	65	25
1/2"	99	76	28
3/4"	109	80	38
1"	117	95	45